

Custom-built Booth Building Regulations

The following regulations have been established by DEMACH GmbH to fit the needs for DRONE Berlin.

Use of Space

Displays materials should be arranged in such a manner so as not to obstruct sight lines of neighboring exhibitors.

Under no circumstances may any part of an exhibitor's display extend outside of the boundary of said exhibitor's contracted exhibit space regardless of the height clearance from the floor of said item.

This rule also applies to lights, speakers, and hanging signs.

Exhibitors with neighbouring booths must ensure that stand elements are carrying no company advertising on any neighbour-facing side. Exhibitors adjacent to another booth must provide their own partitioning wall panels and are not permitted to use the reverse of the neighbour's wall or attach any material to the shell scheme.

Partitioning Wall

Wall panels are not included by the regular price for custom-built booth. However in order to maintain a professional appearance of the exhibit hall, booths must have back sides of displays covered when visible from an aisle and in certain circumstance 2 side walls are also recommended.

There are two types of wall building to fulfill this mandatory requirement: Exhibitors can rent wall panels from the Show Management, or use own portable display systems (e.g.: panels on the back side of a pop-up structure, banner stand, roll up display).

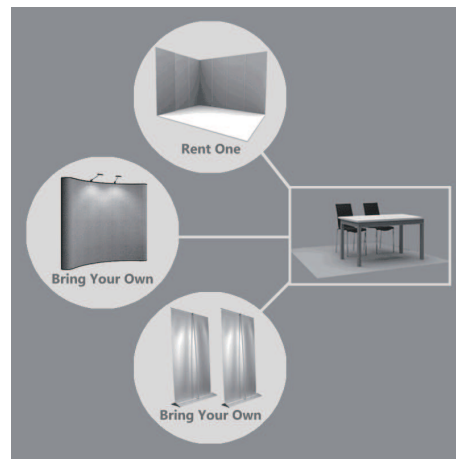

Height Limit

The current height limit is 2.5m in most exhibition areas. Nothing including booth walls may extend above 2.5m from the floor including custom furniture and accessories, lighting, truss, A/V equipment or signage.

Please contact us if you need for higher dimension.

Exhibit Space Lighting and Sound

Without exception, all light and sound must be contained within, and directed into, the footprint of the contracted exhibit space. Additional lighting may be brought in for the exhibit space however this lighting must be restricted to the contracted exhibit space. Lighting should not shine onto the aisles or into a neighbor's exhibit space. Sound must not be at a level that interferes with normal levels of communication in neighboring exhibit space.

Electrical

Within the booth rental a basic power supply is included. Any additional costs related to a main power supply for a booth and the wattage of the booth's electric equipment will be invoiced to each exhibitor separately and is not included in the rental fee. Electrical installations within the booth are also at the exhibitor's expense; however, such installations may only be carried out by an electrician appointed by the Show Management. The Show Management however is not responsible for any losses or damage which may occur from interruptions or defects in the electric power supply.

Flammable or Toxic Materials

All materials used in display construction or decorating should be made of fire retardant materials and be certified as flame retardant. Materials that cannot be treated to meet the requirements should not be used. A flame-proofing certificate should be available for inspection. Exhibitors should be aware of local regulations regarding fire/safety and environment which must be adhered to.